

Application: metal and not metal sheets.

Assembly: with special hand or pneumatic tools.

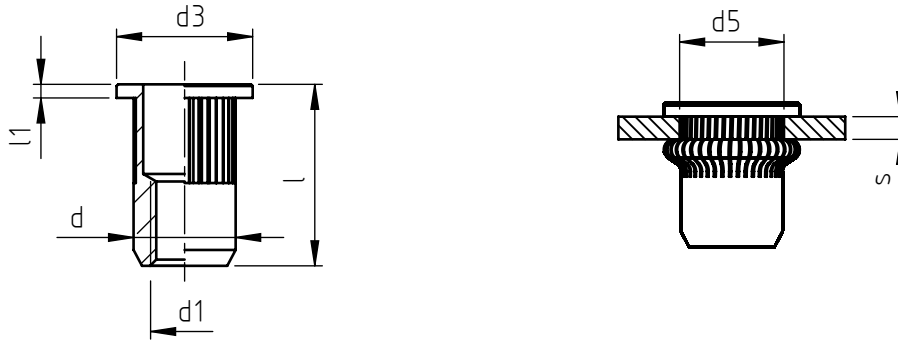

code	s grip	l	d1 6H	d	d3	l1	d5 +0,15 0	l2 *
TC M 6/TZ	0,5 ÷ 3,0	16	M 6	9	12	1,2	9	9,5

Non binding dimensions, expressed in mm.

* Dimension determined from the average of the grip "s" min and max values.

Material: TITANIUM
 Finishing: natural (other finishes on demand)
 Tolerance: according to UNI standards EN 22768-1
 Thread: ISO 6 H metric

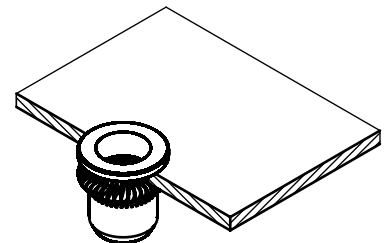

SPECIALINSERT® COMMITS ITSELF TO CONTINUOUSLY IMPROVE ITS PRODUCTS. IT RESERVES THE RIGHT TO CHANGE THEIR TECHNICAL AND STRUCTURAL CHARACTERISTICS WITHOUT PRIOR NOTICE. ALL RIGHTS ARE RESERVED AND THE DUPLICATE, EVEN PARTIAL, OF THESE DOCUMENTS, AS WELL AS ITS DISTRIBUTION TO THIRD PARTIES, ARE FORBIDDEN, UNLESS OTHERWISE AND EXPRESSLY AUTHORIZED BY SPECIALINSERT.